

SIDE MOUNT HOSE REELS WITH GUIDE ARM **SG & SGW SERIES**

COXREELS® SG & SGW Series expand the capabilities of the “Side Mount” spring driven hose reels, adding a multi-position guide arm for maximum and convenient hose control. Ideal for tight spaces, the versatile SG Series (for air/water, oil and grease) and SGW Series (for oxy-acetylene and T Grade gas welding hose) feature a simple two-bolt mounting pattern for easy installation and detachment on any vertical flat surface. Common applications include service vehicles, tool benches, vertical walls and beams, vehicle lift systems, machine tools and more. The guide arm and roller assembly are easily moved to one of the six different positions with a standard 1/2” wrench.

SG SERIES LOW PRESSURE

Models with hose are for air or water service with a maximum temperature 150° F. Models less hose can be used for air, water or oil. **Note: Do not exceed listed hose O.D. to obtain maximum length.**

HOSE							LESS HOSE		SIZE INDEX
MODEL	I.D.	O.D.	FT.	PSI	APRX. LBS.	AVAILABLE IN EZ-COIL	MODEL	APRX. LBS.	
SG13-L125	1/4"	1/2"	25'	300	25	EZ-SG13-L125	SG13L-L125	22	1
SG13-L135	1/4"	1/2"	35'	300	26	EZ-SG13-L135	SG13L-L135	23	1
SG13-L325	3/8"	5/8"	25'	300	26	EZ-SG13-L325	SG13L-L325	23	2
SG17-L350	3/8"	5/8"	50'	300	40	EZ-SG17-L350	SG17L-L350	33	3
SG17-L430	1/2"	3/4"	30'	300	42	EZ-SG17-L430	SG17L-L430	37	3
SG19-L450	1/2"	3/4"	50'	300	52	EZ-SG19-L450	SG19L-L450	44	5

To order EZ-Coil® equipped models less hose, please add prefix "EZ-"

SG SERIES MEDIUM PRESSURE

Reels are furnished with standard one wire braid hose suitable for air, water or oil applications. Hose exceeds SAE R1 specifications. Maximum temperature 250° F. **Note: Do not exceed listed hose O.D. to obtain maximum length.**

HOSE							LESS HOSE		SIZE INDEX
MODEL	I.D.	O.D.	FT.	PSI	APRX. LBS.	AVAILABLE IN EZ-COIL	MODEL	APRX. LBS.	
SG17-M325	3/8"	11/16"	25'	3000	46	EZ-SG17-M325	SG17L-M325	39	3
SG19-M350	3/8"	11/16"	50'	3000	63	EZ-SG19-M350	SG19L-M350	51	5
SG17-M425	1/2"	13/16"	25'	2500	46	EZ-SG17-M425	SG17L-M425	39	4
SG19-M450	1/2"	13/16"	50'	2500	65	EZ-SG19-M450	SG19L-M450	51	6

To order EZ-Coil® equipped models less hose, please add prefix "EZ-"

SG SERIES HIGH PRESSURE :: HP

Reels are furnished standard with S.A.E. 100R16 #1 or #2 wire braid hose suitable for grease and hydraulic oil applications. Maximum temp. 250° F. **Note: Do not exceed listed hose O.D. to obtain maximum length.**

HOSE							LESS HOSE		SIZE INDEX
MODEL	I.D.	O.D.	FT.	PSI	APRX. LBS.	AVAILABLE IN EZ-COIL	MODEL	APRX. LBS.	
SG17-H125	1/4"	9/16"	25'	5000	45	EZ-SG17-H125	SG17L-H125	39	4
SG19-H150	1/4"	9/16"	50'	5000	62	EZ-SG19-H150	SG19L-H150	51	7
SG17-H325	3/8"	11/16"	25'	4000	46	EZ-SG17-H325	SG17L-H325	39	4
SG19-H350	3/8"	11/16"	50'	4000	63	EZ-SG19-H350	SG19L-H350	51	8

To order EZ-Coil® equipped models less hose, please add prefix "EZ-"

SGW SERIES WELDING HOSE REELS :: SGW

Hose supplied on reel Oxy-Acetylene or T-Grade. Oxy-Acetylene is twin-siemese type meeting R.M.A. and C.G.A. type V.D. grade R specifications. Use of other types of hose is not recommended. Reels with "T Grade" hoses are used for a wide variety of gases, such as MAPP, propane, natural and fuel. **Note: Do Not Exceed Listed Hose O.D. To Obtain Max. Length.**

HOSE							LESS HOSE		SIZE INDEX
MODEL	GAS	I.D.	FT.	PSI	APRX. LBS.	AVAILABLE IN EZ-COIL	MODEL	APRX. LBS.	
SG17W-150	Oxy/Act	1/4"	50'	200	59	EZ-SG17W-150	SG17WL-150	47	9
SG19W-175	Oxy/Act	1/4"	75'	200	77	EZ-SG19W-175	SG19WL-175	60	10
SG17WT-150	T Grade	1/4"	50'	200	59	EZ-SG17WT-150	SG17WTL-150	47	9
SG19WT-175	T Grade	1/4"	75'	200	77	EZ-SG19WT-175	SG19WTL-175	60	10

To order EZ-Coil® equipped models less hose, please add prefix "EZ-". Less hose SGW Series models comes with inlet hose

REEL DIMENSIONS

Technical Data Sheets Available On Website

SIZE INDEX	W	H	L	Y	M
1	6 1/4"	15 1/2"	13 1/2"	14"	2 1/2"
2	6 3/4"	15 1/2"	13 1/2"	14"	2 1/2"
3	6 3/4"	19 1/2"	17"	18"	2 1/2"
4	7 1/4"	19 1/2"	17"	18"	2 1/2"
5	8 1/2"	22"	19 1/2"	20 1/2"	2 7/8"
6	9 3/8"	22"	19 1/2"	20 1/2"	2 7/8"
7	9"	22"	19 1/2"	20 1/2"	2 7/8"
8	9 1/2"	22"	19 1/2"	20 1/2"	2 7/8"
9	8 7/8"	19 1/2"	17"	18"	2 1/2"
10	10 1/2"	22"	19 1/2"	20 1/2"	2 1/2"

Overall Dimensions - Base - Mounting Pattern

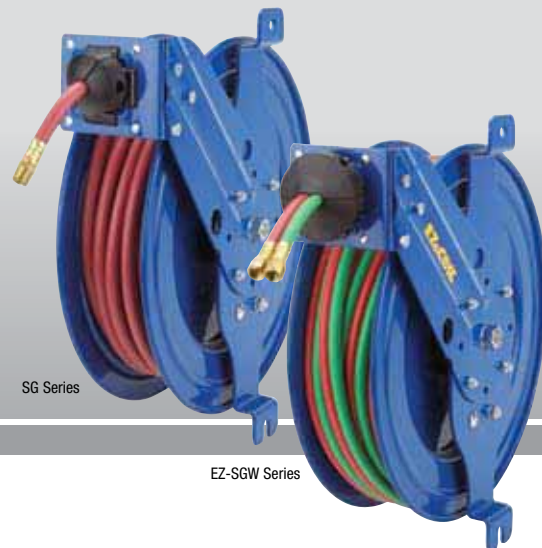
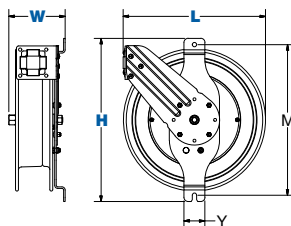

EZ-SGW Series

SG SERIES :: REEL SPECIFICATIONS

SWIVEL

- External fluid path with machined from solid brass 90° full-flow NPT swivel inlet (Zinc plated steel swivel on HP models)
- Swivel Seals: NITRILE
- External fluid path with 90° full-flow dual ported brass swivel offering both connections from the same side of the reel (On SGW Models)
- Swivel Seals: VITON® (On SGW Models)

DESIGN & STRUCTURE

- Side mount design for vertical flat surface, cabinet or enclosed space mounts
- Adjustable 6 position guide arm & roller assembly provide maximum hose control
- 2-bolt mounting pattern easily mounts & detaches for temporary or permanent installation
- Solid one piece, 3/16" steel arm base for maximum stability
- 1" solid steel axle & lubricated precision bearings for smooth rotation

RETRACTION

- Controlled retraction speed up to 80% slower on EZ-COIL models :: See page 7 for details
- Enclosed factory tuned & matched cartridge-style spring motor
- Non corrosive stainless steel spring, pawl & zinc plated ratchet
- Multi-position lock ratchet mechanism secures hose at desired length.
- Non-locking, less ratchet option available (add suffix -BXC)

SIGNATURE FEATURES

- Professional grade heavy duty steel construction
- Durable proprietary CPC™ powder coat process
- Rolled edges & ribbed discs provide strength & safety
- Leading 2-year manufacturer's limited warranty
- Made in the U.S.A. - Sold & Supported Worldwide

POSSIBLE FIELDS OF APPLICATION

- Air/Water Services
- Pneumatic Tools
- Welding Shops
- Service / Mechanic / Utility Vehicles
- Lubrication
- Chemical Fluid Transfer
- General Industrial
- Construction Sites

ACCESSORIZE YOUR REEL :: PG 50

- O-Rings & Swivels
- Hoses
- Assorted Reel Accessories

